

VR Connect: Virtual Reality-based Social Skills Training Intervention For Socially-Challenged Students



Background & Objective



Social challenges



Limited resources



Holistic development

Advantages of adopting VR in training students with SEN

Easy-to-tailor training
with modularized
programme

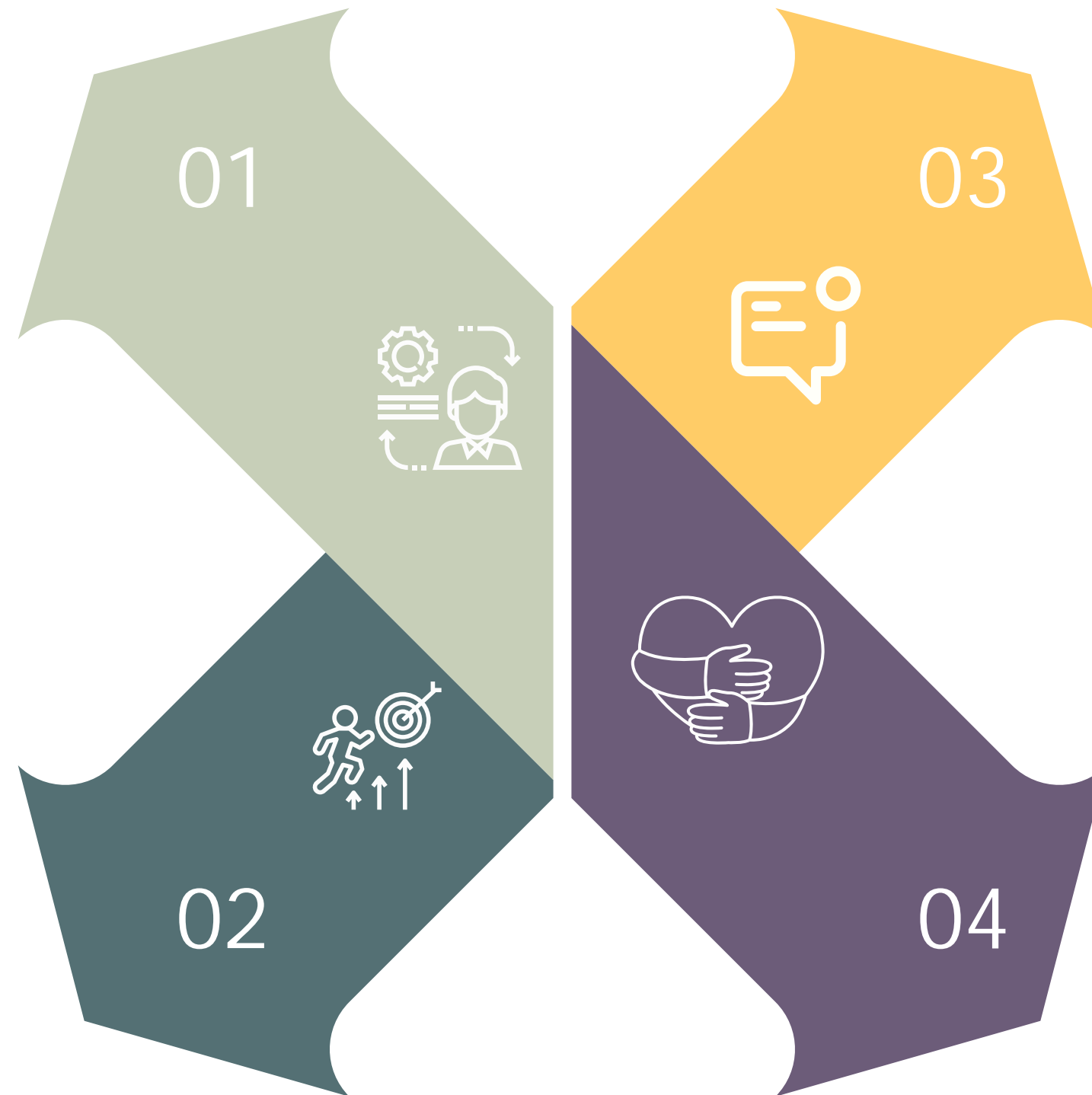

Standardized and
repeatable
step-by-step in an
immersive VR
environment

Engaging and interactive
Innovative and
interesting

Reduced stress and
anxiety during practice
less stressful compared to
conventional training

Outcomes and Effectiveness of the Previous VR Project

Number of Beneficiaries

121 Individuals with ASD

16 Universities / Colleges / schools

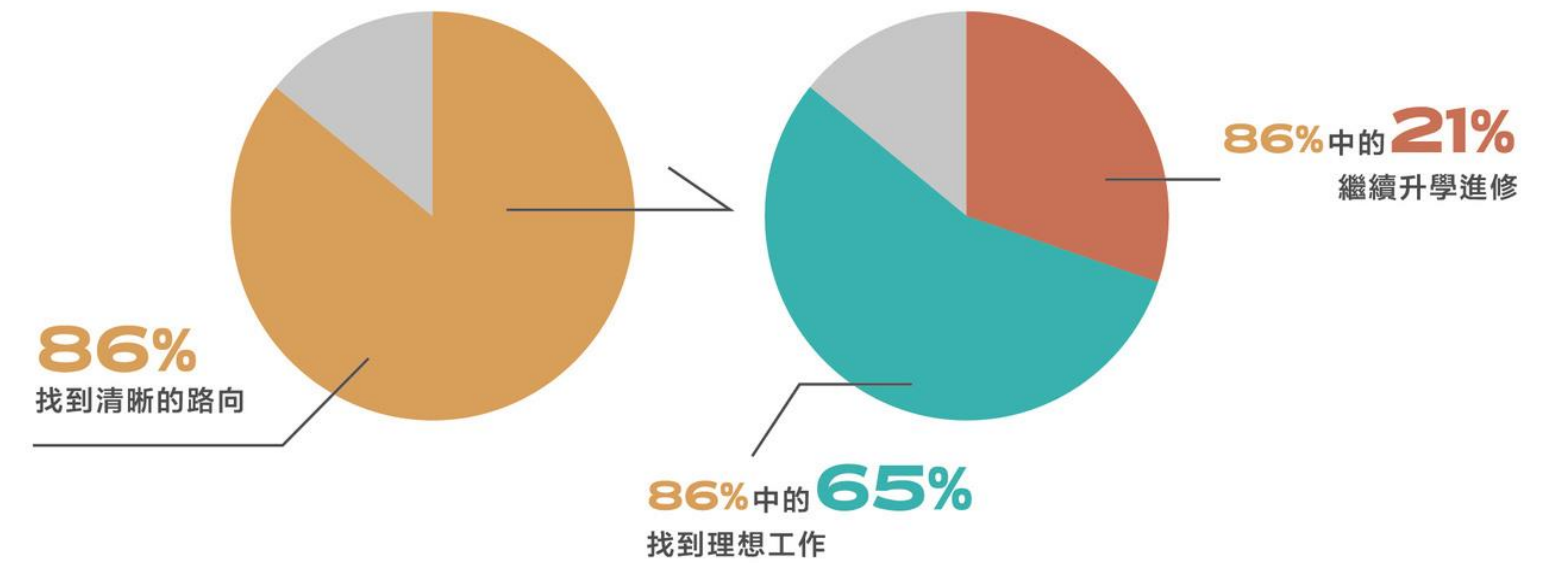

生涯適應力量表

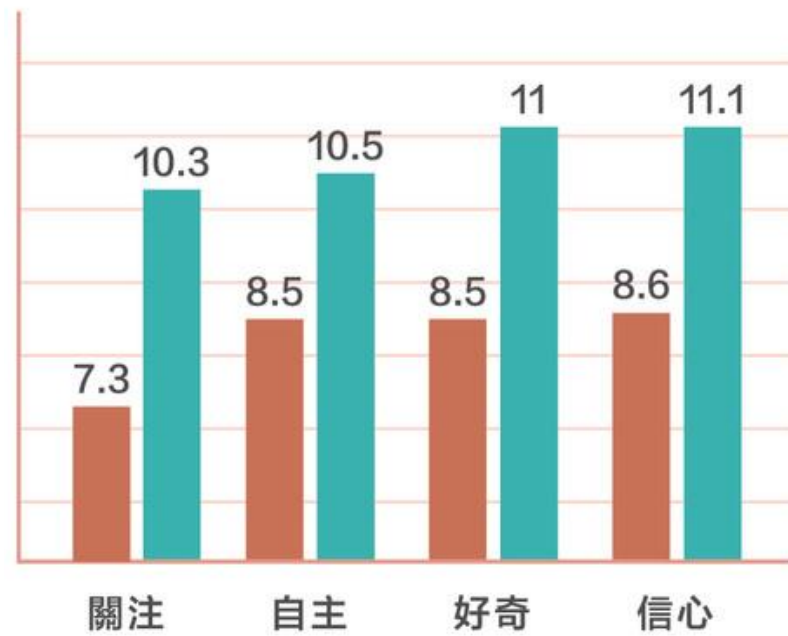

職業決策自我效能量表

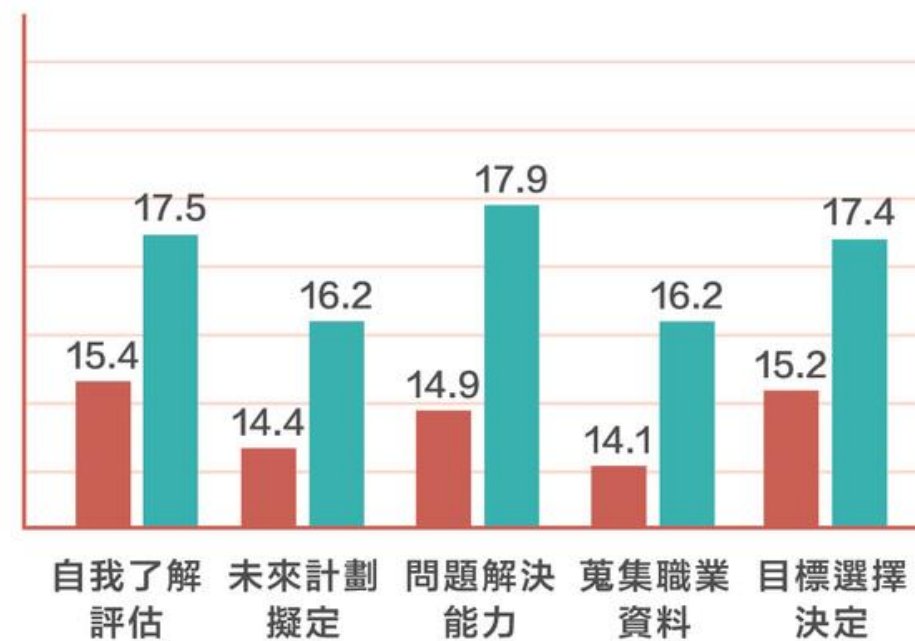

多元社交力量表

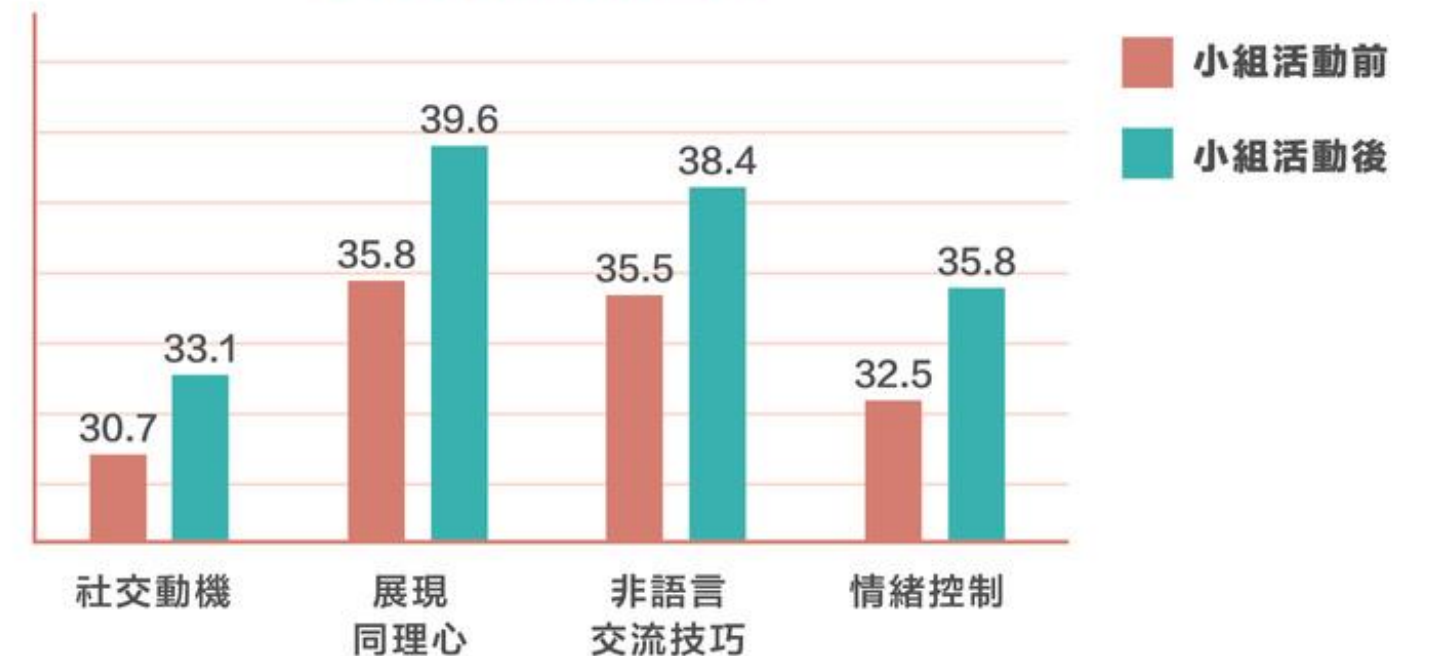

Training Themes

Social Skills for Group Work

Forming Groups



Getting along with Groupmates



Handling Different Opinions



Reporting Difficulties



Enquiring Progress and Providing Support



Moving On & Maintaining Relationship



Integrating Technology with Evidence-based Practice

CBT-based intervention

- ✓ Didactic Teaching
- ✓ Modeling
- ✓ Behavioral Rehearsal
- ✓ Perspective-taking Questions
- ✓ Coaching with Performance Feedback
- ✓ Homework Assignment

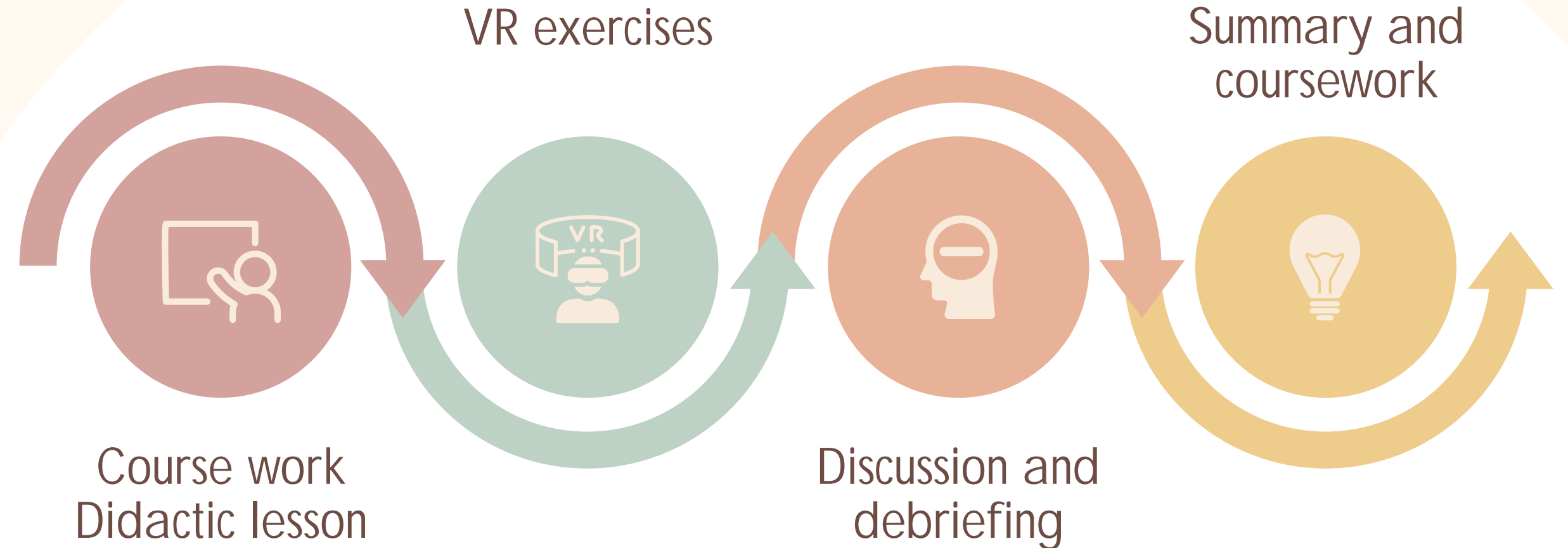

(Steinbrenner et al.,
2020)

Demo session



Q & A



CONTACT US

USSEN@HKBU.EDU.HK

+852-34112824

A Preview of Village CARE

HKBU Secondary School Principals' Day 2024



Jockey Club Campus of Creativity (JC³)



Jockey Club Campus of Creativity

The Jockey Club Campus of Creativity (JC³) integrates

- Village CARE (Creative Arena for Residential Education)
- Jockey Club Creative Hub



Jockey Club Campus of Creativity

- First student complex in Hong Kong that combines teaching and learning, creativity and living spaces.
- To be commissioned in 2024/25



Location

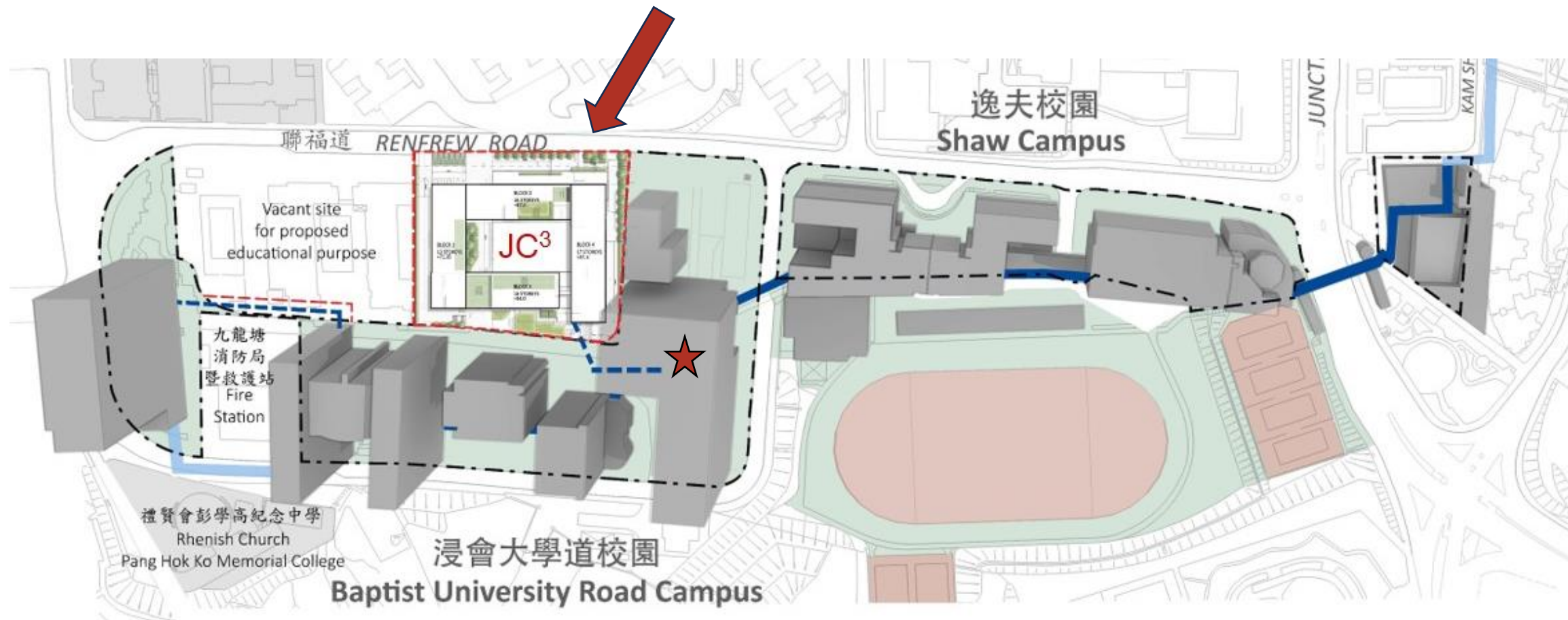

Design Scheme



Aerial View



Outdoor Courtyard on 3/F



Exterior View (January 2024)



from North-East side



from South side



Exterior View (January 2024)



from Renfrew Road (North)



from Renfrew Road (South)



Village CARE



Vision and Mission

Vision

- To offer the **best learning experience** for students in a residential setting, delivering transdisciplinary academic excellence in a **caring, creative, and global culture**.

Mission

- To enable student residents to care for the common good of humankind by addressing creatively the local and global challenges through its **transdisciplinary thematic** curricular and co-curricular programmes in the residential setting.



Residential Education Learning Outcomes

- Residential Education aims to work in **synchrony with the formal curriculum** to provide the best student experience for the achievement of whole person development and best student experience.
- Upon completion of their living learning experiences at Village CARE, students will:
 1. Demonstrate intrapersonal awareness, personal wellness & interpersonal lifestyle indicative of **whole person development**;
 2. Actively pursue academic learning, both in depth and breadth, showing a capacity for **independent lifelong learning**;
 3. Actively and responsibly **engage in the community** – from Village CARE to the community, both local and global;
 4. Solve problems creatively and with **critical thinking**; and
 5. Be **effective leaders and members** in transdisciplinary and culturally diversified teams.



High Table Dinner



4 Colleges in 4 Blocks



Building Overview

Demarcation Diagram for Hostel Blocks

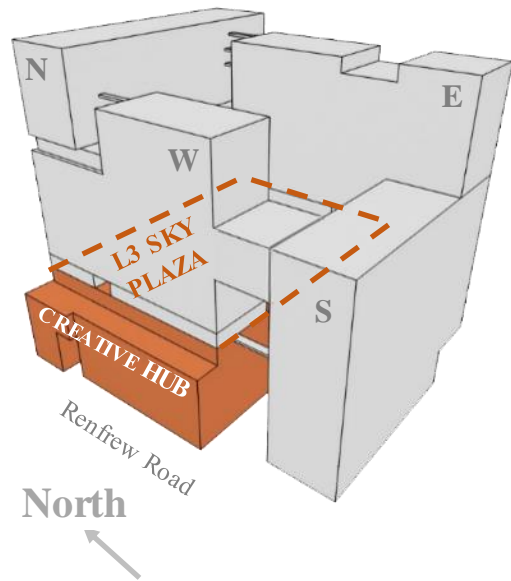

Hostel North Block (Block 4)

Hostel West Block (Block 2)
(Lo Siu Tong College 羅肇唐書院)

STUDENT ACTIVITY CENTRE on 2/F and 3/F

Jockey Club Creative Hub

L3 Courtyard Plaza

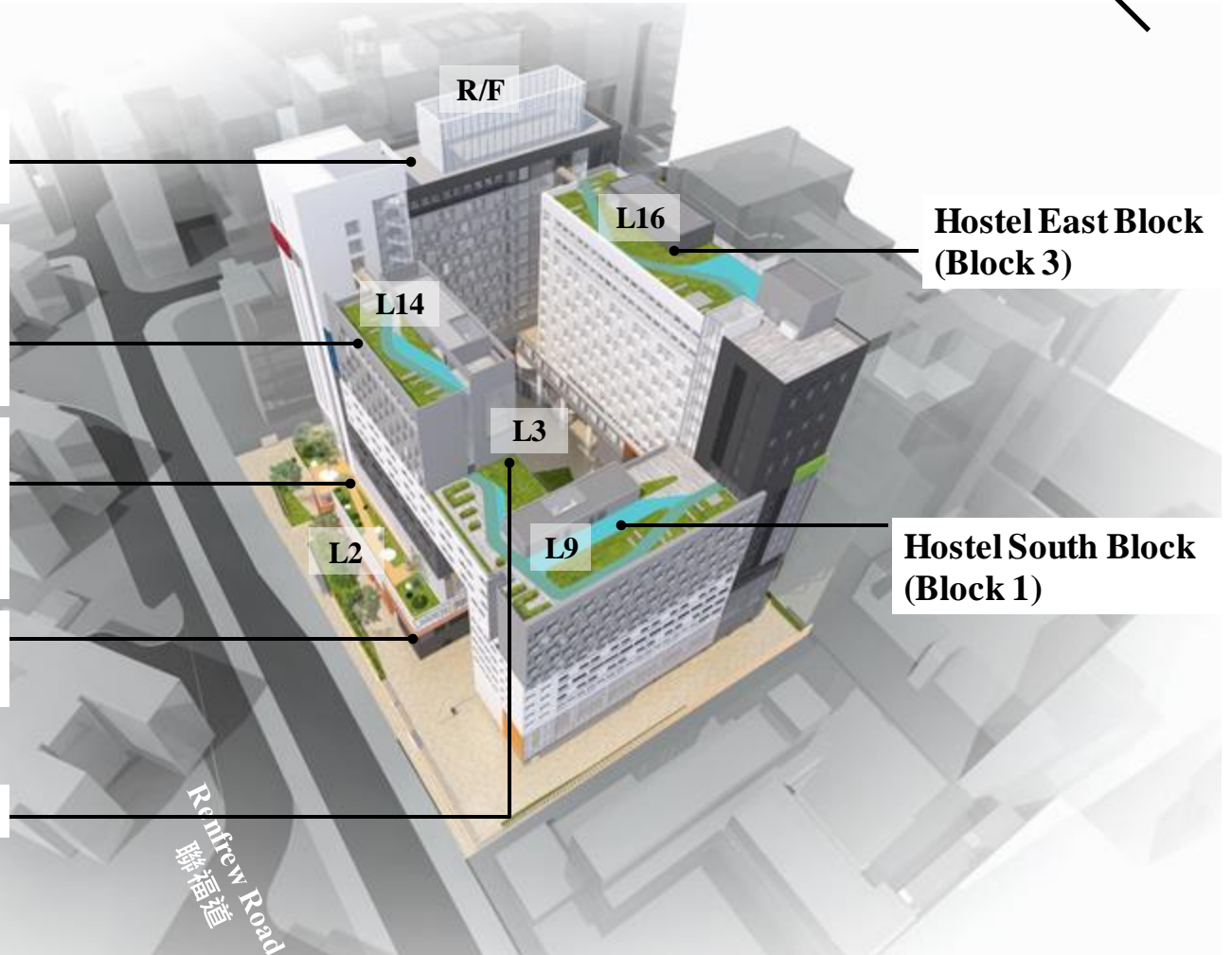

Themes for the 4 Colleges

1. **Arts and Culture** (Aesthetic values / performance / visual art) [篤學尚雅]
2. Purpose-driven innovative **business and entrepreneurial** mindset [信義日新]
3. Sportsmanship and **Wellness** [力強志剛]
4. Community **Services Leadership** [行德臻善]

* *The first Chinese character word of each of the four examples of College theme form the University motto—篤信力行 (Faith and Perseverance).*



Leadership Team

- **College Master (1 per College):**
 - Senior Academic Staff
 - Responsible for the Credit-bearing Residential Education and Pastoral Duties
- **College Fellows (1-2 per College):**
 - University staff or Senior Professional
 - Supporting College Master to conduct Credit-bearing Residential Education
- **College Tutors (~10 per College):**
 - Post-graduate Students
 - Serving as a role model and mentor for residents of their floors; Supporting the College Master and Fellows.



Village CARE Unit / Apartment



Room Types

	2P	3P	7P	4P
No. of Bedspaces in a Unit / Apt.	2	3	7	4
Room Type	Single Room			Twin Room
No. of Rooms in a Unit / Apt.	2	3	7	2
Shared Pantry	No		Yes	No
Total No. of Unit / Apt.	3	55	33	331
Total No. of Bedspaces	6	165	231	1324



Layout

2P

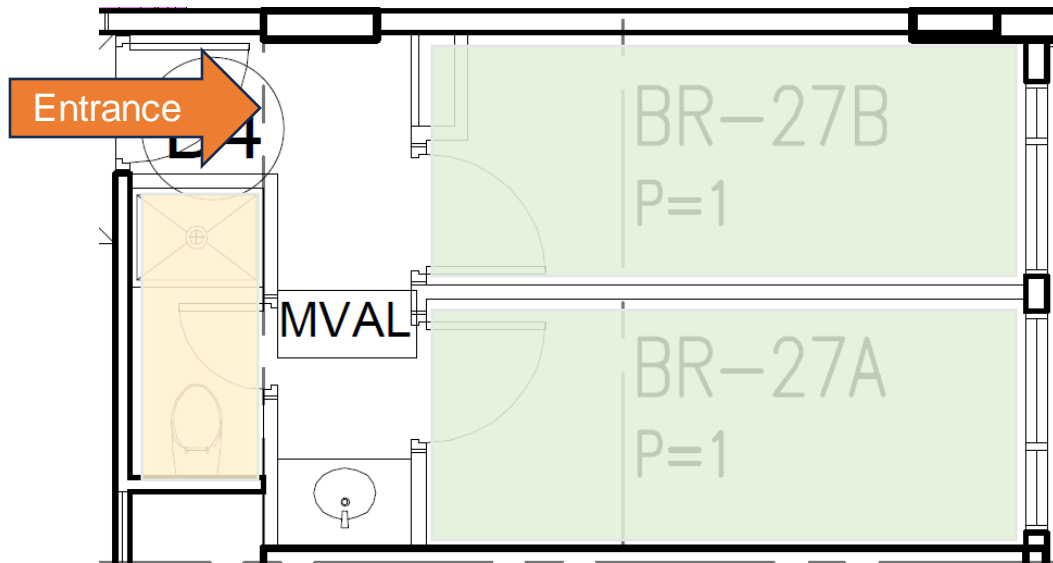

Bedroom

Shared Washroom

3P

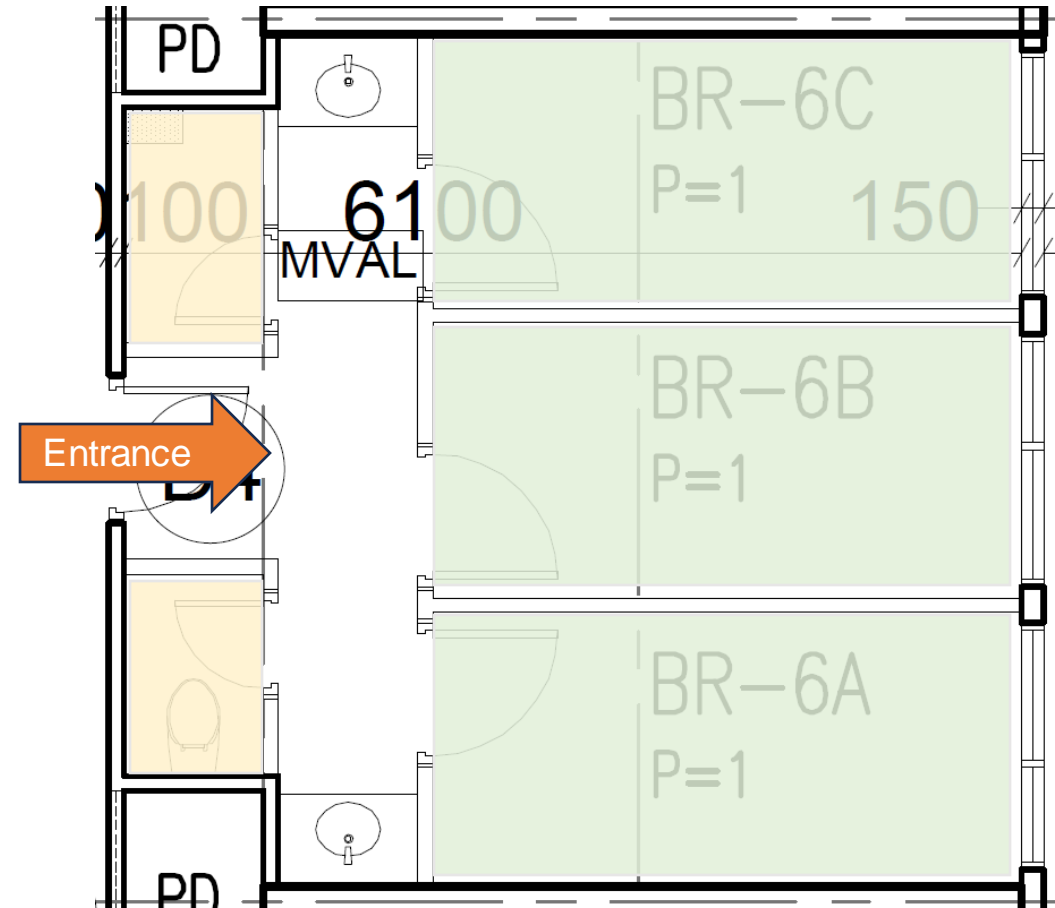

Layout

7P

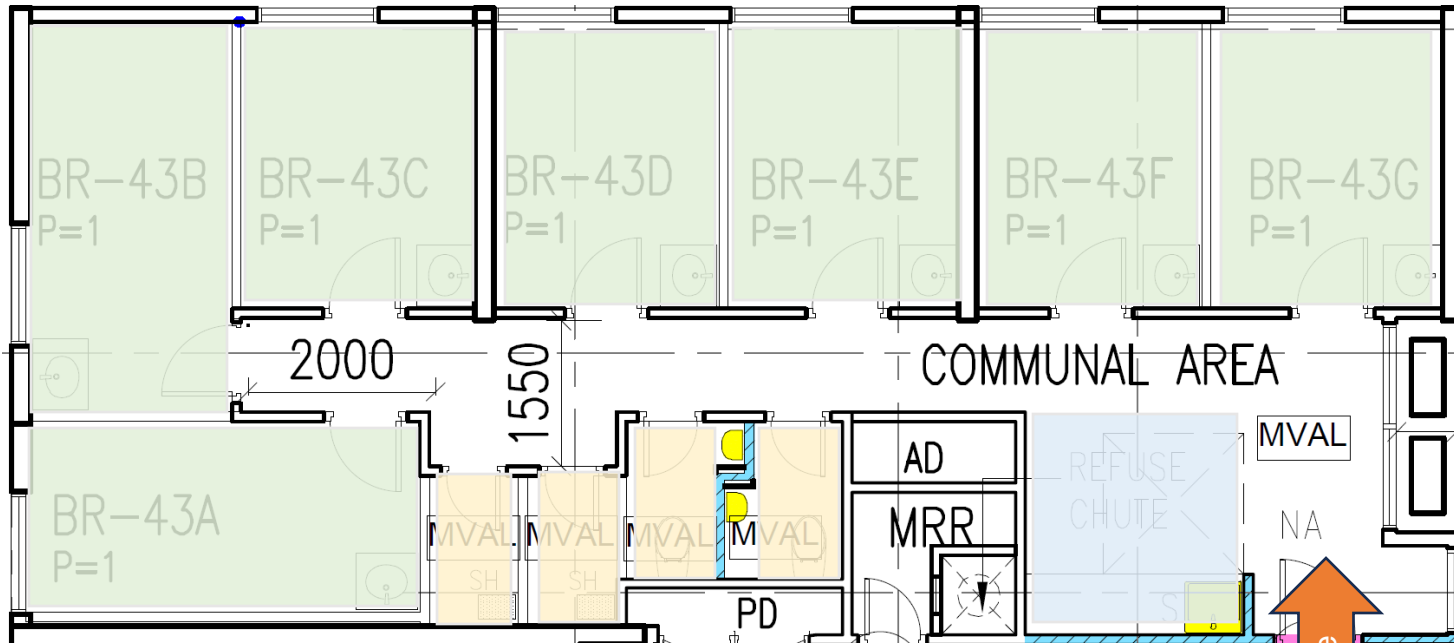

- Bedroom
- Shared Washroom
- Shared Pantry

4P

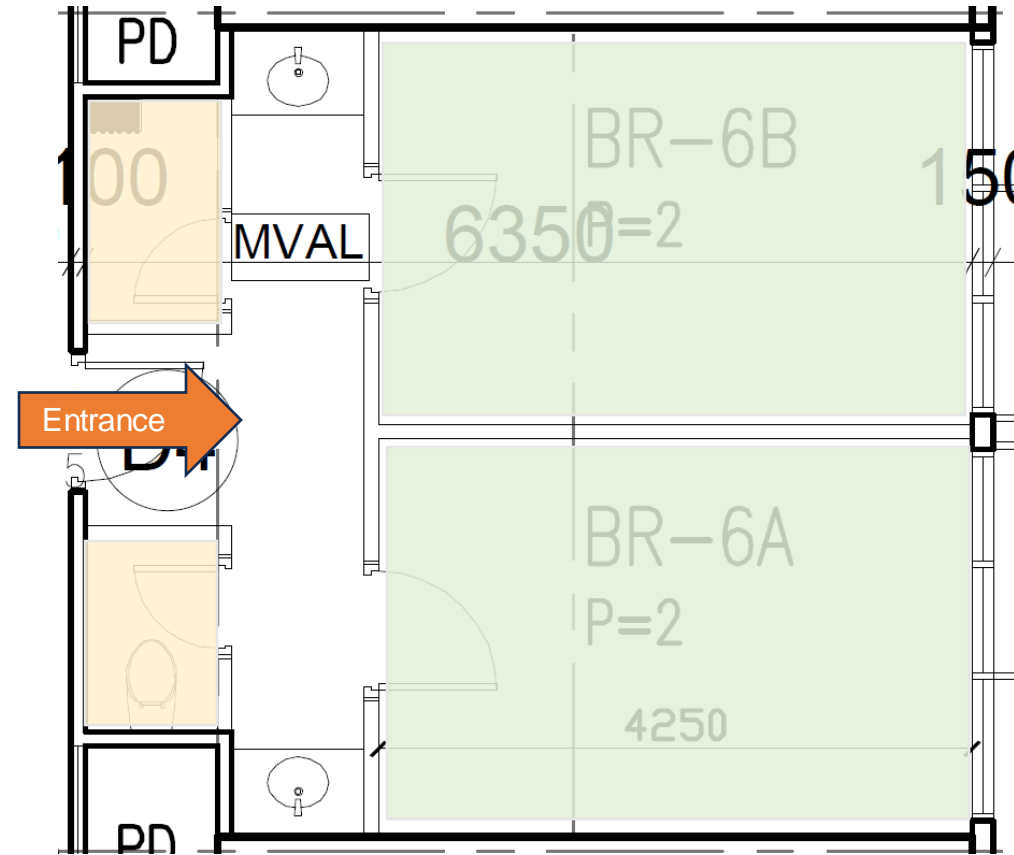

Mock-up Room (4P)



Mock-up Room (3P)



Mock-up Room (2P / 3P / 4P)



Mock-up Room (7P)



Q & A





Thank You!